

- Ⓐ Power inlet (φ60). Breaker capacity (factory) 75A (D300B:150A)
- Ⓑ Water for hopper throat IN:PT3/8 with Y-type strainer  
(Nomal water volume:5 to 10 l/min.)
- Ⓒ Water for hopper throat OUT:PT3/8
- ※ Overall machine height increases by approx.  
47mm with optional rubber pads attached.

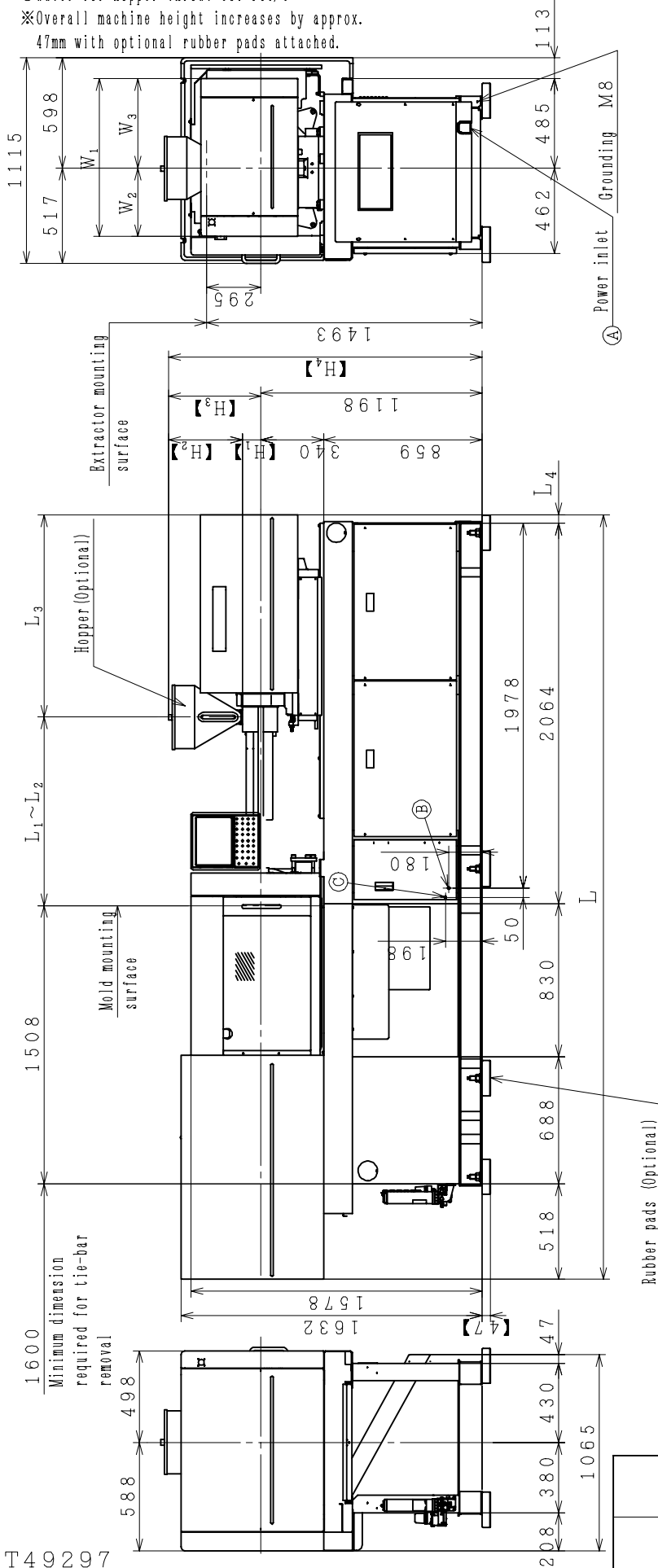

	L	L <sub>1</sub>	L <sub>2</sub>	L <sub>3</sub>	L <sub>4</sub>	W <sub>1</sub>	W <sub>2</sub>	W <sub>3</sub>	【H <sub>1</sub> 】	【H <sub>2</sub> 】	【H <sub>3</sub> 】	【H <sub>4</sub> 】
1. 5H	φ20	4100	761	471	1118	-195	855	370	485	401	481	1679
1. 5H · 2. 5H	φ24	4100	848	558	1101	-125	855	370	485	401	481	1679
2. 5U	φ28	4100	944	654	1101	-25	855	370	485	401	501	1699
2. 5H · 2. 5U	φ32	4173	1021	731	1126	73	855	370	485	505	625	1823
3. 5S · 3. 5H	φ28	4400	944	654	1470	340	1107	475	632	401	501	1699
3. 5S · 3. 5H	φ32	4541	1021	731	1494	441	1107	475	632	505	625	1823
	φ36	4624	1104	814	1494	524	1107	475	632	505	625	1823
7H	φ40	4742	1202	912	1514	642	1107	475	632	505	630	1828
7H	φ46	4814	1238	1048	1550	714	1107	475	632	570	695	1893

Figures in [ ] show dimensions with options.

100MEt III (CE)

OUTSIDE VIEW

T49297

10-900